

## Introduction

Heldon liquid line filter driers offer a high level of protection for refrigeration and air-conditioning systems. Designed to remove moisture, acids and solid particles that can lead to premature component failure and harmful chemical reactions.

## Features

- Solid core constructed with optimized binding agent.
- Pre and post core filters.
- 100% Molecular Sieve core
- Solid copper sweat and zinc plated flare connections.
- Powder coated UL approved shell.



Liquid Capacity Table

Connection	Part Numbers		R22	R404A	kw
	Flare	Solder	R407C R410a	R134a R507	
1/4	3000-032	3001-032S	7	7	5
3/8	3000-033	3001-033S	19	17	13
1/4	3000-052	3001-052S	8	7	5
3/8	3000-053	3000-053S	19	18	14
1/4	3000-082	3001-082S	8	7	5
3/8	3000-083	3001-083S	21	19	14
1/2	3000-084	3001-084S	29	26	20
1/4	3000-162	3001-162S	8	7	5
3/8	3000-163	3001-163S	24	22	16
1/2	3000-164	3001-164S	33	30	22
5/8	3000-165	3001-165S	47	43	30
3/8	3000-303	3001-303S	23	21	15
1/2	3000-304	3001-304S	34	31	22
5/8	3000-305	3001-305S	49	45	33
3/4	3000-306	3001-306S	65	59	43
7/8		3001-307S	65	59	43
3/8	3000-413	3001-413S	27	25	18
1/2	3000-414	3001-414S	35	32	23
5/8	3000-415	3001-415S	55	53	37
3/4	3000-416	3001-416S	100	91	65
7/8		3001-417S	100	91	65

Drying Capacity Tables  
kg refrigerant

R22 R407C R410A	R134a R507		R404A		Drops of Water @24°C	
	24°	52°	24°	52°		
6.5	6	7	6.5	11	6	150
6.5	6	7	6.5	11	6	150
8	7	8.5	8	13	7.5	260
8	7	8.5	8	13	7.5	260
12.5	11	12.5	12	20	11.5	400
12.5	11	12.5	12	20	11.5	400
12.5	11	12.5	12	20	11.5	400
27	23	27	25.5	43	24	870
27	23	27	25.5	43	24	870
27	23	27	25.5	43	24	870
27	23	27	25.5	43	24	870
57	48.5	58	54	92	51	1850
57	48.5	58	54	92	51	1850
57	48.5	58	54	92	51	1850
57	48.5	58	54	92	51	1850
80	74	80	75	130	70	2600
80	74	80	75	130	70	2600
80	74	80	75	130	70	2600
80	74	80	75	130	70	2600

Given in accordance with ARI 710-86 for;  
Evaporator temperature; te = -15°C  
Condensing temperature; tc = 30°C  
Pressure drop P = 7kpa (1 psi)

Drying Capacity based on moisture content reduction requirements as follows;  
R22, R410A: down to 60ppm  
R407C, R404a, R507: down to 30ppm  
R134a: down to 75ppm

## Dimensions

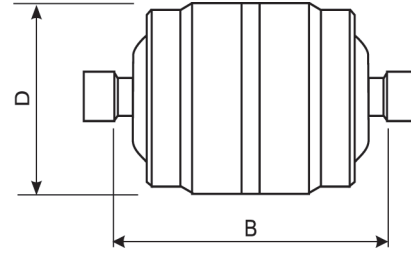
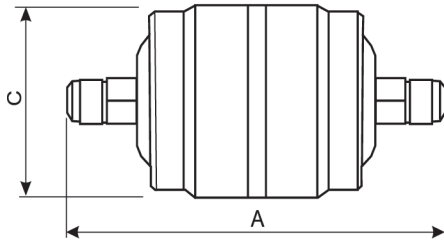

### Dimensions, Weights & Carton Quantities

Part No.	A mm	C mm	Weight kg	Carton qty
3000-032	110	64	.255	48
3000-033	110	64	.310	48
3000-052	110	64	.395	40
3000-053	110	64	.435	40
3000-082	136	64	.515	24
3000-083	147	64	.550	24
3000-084	152	64	.580	24
3000-162	157	78	.750	18
3000-163	168	78	.790	18
3000-164	175	78	.825	18
3000-165	185	78	.895	18
3000-303	250	78	1.235	12
3000-304	250	78	1.290	12
3000-305	258	78	1.345	12
3000-306	258	78	1.370	12
3000-413	245	90	1.865	8
3000-414	255	90	1.885	8
3000-415	255	90	1.935	8
3000-416	269	90	1.965	8

Part No.	B mm	D mm	Weight kg	Carton qty
3001-032S	110	64	.225	48
3001-033S	110	64	.260	48
3001-052S	110	64	.360	40
3001-053S	110	64	.380	40
3001-082S	110	64	.480	24
3001-083S	136	64	.485	24
3001-084S	136	64	.495	24
3001-162S	156	78	.755	18
3001-163S	156	78	.805	18
3001-164S	156	78	.820	18
3001-165S	158	78	.895	18
3001-303S	238	78	1.210	12
3001-304S	238	78	1.250	12
3001-305S	238	78	1.270	12
3001-306S	238	78	1.290	12
3001-307S	241	78	1.310	12
3001-413S	238	90	1.805	8
3001-414S	238	90	1.815	8
3001-415S	238	90	1.825	8
3001-416S	238	90	1.835	8
3001-417S	250	90	1.870	8

- Weight kg refers to packaged weight of drier
  - Carton Qty refers to master carton box quantity
- Pallet quantities can be confirmed on request

## Manufacturing Standards

Manufactured in accordance with AS 2971 or UL207  
 Safe Working Pressure: 4,200 kPa