

Introduction

Heldon offers a flexible replacement solution with an encapsulated coil range that fits the following normally closed solenoid valves:

Coil 2406 fits the new (in 2009) Heldon 2402 and 2403 series and Castel solenoid valves .

Coil 2406-EVR fits Danfoss type EVR solenoid valves.

Coil 2405 fits the old Heldon 2400 and 2401 series .

Test Magnetic Coil 2406-MAG fits Heldon , Danfoss & most other popular brands.

The 2406 series coils provides the service market with the added bonus of stocking less replacement coils to suit 2+1 brands and is available to suit all popular for AC voltage applications.

The new 2406 series also has the added visual diagnostic feature of an LED light that is illuminated to indicate when power is in supply condition to the coil.

The 2405-MAG Permanent Magnet, allows the valve to be energized without power supply, during system commissioning, e.g.. nitrogen charging for leak testing and during pipe welding. Fits Heldon & most other popular brands.

Both 2405 & 2406 coils are a rugged moisture proof design with simple click-on mounting and are IP65 rated with the CE mark to meet low the voltage directive of Europe (LVD) 73/23/EC where applicable.



2406



2406-EVR



2405-MAGNET



2406-DIN-LED

Features and Benefits

Features

- Compact design
- Low wattage coil saves power (2406)
- LED light feature saves service time
- UV Stabilized outer shell for tough hot environments
- Hirschman style din plug
- Coil operating Temperature -40/80°C
- Voltage tolerance, + or - 10% of coil rated voltage

Benefits

- Flexible service solution, fits 2+1 brands
- Saves stocking costs
- Simple click- on mounting for ease of fitting
- Covers popular AC and DC voltage applications
- Encapsulated design protects from water, oils and dirt

Manufacturing Standards

Manufactured in accordance with AS / NZ 1677

Solenoid Coil Range - 2406 Series

Fits new series 2402 & 2403 Solenoid Valves

Coil Series 2406 Part No.	Suit Valve Series	Brands Coil Fits	Supply Voltage V a.c / DC	Frequency H/z	Power Cons AC	Power Cons DC	Temp. Range	Weight kg	Inner Pack Qty	Outer Pack Qty
2406-240-AC	2402 Flare & 2403 Solder	Heldon / Castel	240 V a.c.	50/60	9W	-	-40/80°C	0.190	1	20
2406-240-AC	2402 Flare & 2403 Solder	Heldon / Castel	110 V a.c.	50/60	9W	-	-40/80°C	0.190	1	20
2406-240-AC	2402 Flare & 2403 Solder	Heldon / Castel	24 V a.c.	50/60	9W	-	-40/80°C	0.190	1	20
2406-240-AC	2402 Flare & 2403 Solder	Heldon / Castel	12 V DC.	-	-	9W	-40/80°C	0.190	1	20
2406-EVR-240-AC	EVR Danfoss - Flare & Solder	Danfoss	240 V a.c.	50/60	10W	-	-40/80°C	0.315	1	20
2406-EVR-24-AC	EVR Danfoss - Flare & Solder	Danfoss	24 V a.c.	50/60	10W	-	-40/80°C	0.315	1	20
2406-EVR-12-DC	EVR Danfoss - Flare & Solder	Danfoss	12 V DC	-	-	10W	-40/80°C	0.315	1	20
2405-MAG	2405 / 2406 / EVR *	Heldon / Castel / Danfoss	-	-	-	-	-40/80°C	0.120	1	1
2406-DIN-LED	EVR Danfoss - Flare & Solder **	Danfoss	-	-	-	-	-40/80°C	0.020	1	20

*Permanent Magnetic Coil

**Terminal Assemble for 2406-EVR

Coil Series 2405

Part No.	Suit Valve Series	Supply Voltage	Frequency H/z	Power Consumption AC Watts	Power Consumption DC Watts	Temp. Range	Weight kg	Inner Pack qty	Outer Pack qty
2405-240V-AC	2400 Flare & 2401 Solder	240 V a.c.	50/60	9W	-	-40/80°C	0.19	1	20
2405-24V-AC	2400 Flare & 2401 Solder	24 V a.c.	50/60	9W	-	-40/80°C	0.19	1	20
2405-MAG	2405 / 2406 / EVR *	-	-	-	-	-40/80°C	0.120	1	1

*Permanent Magnetic Coil



2406 With Terminal Box

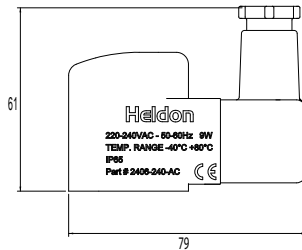

2406-DIN-LED

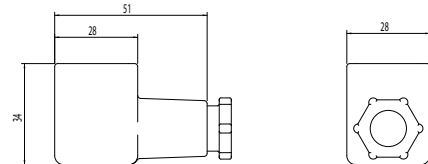

2406

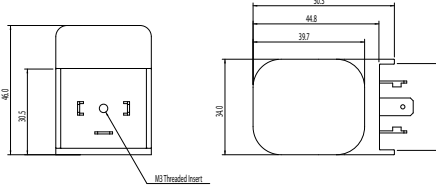

2406-EVR

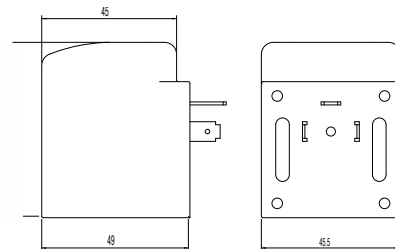

2405-MAG

