

## Introduction

Heldon's range of demountable filter drier shells are designed to be used in both the liquid and suction lines of refrigeration and air-conditioning systems using fluorinated refrigerants.

Shells are made from steel tube with solid copper connectors, R-717 rated shells with steel connectors are available on request. Shells have a corrosion resistant powder coat finish. Test certificates are available on request.

**The new Heldon Demountable Drier comes with a unique filter cup - this cleans the internal wall as you remove the assembly during service.**

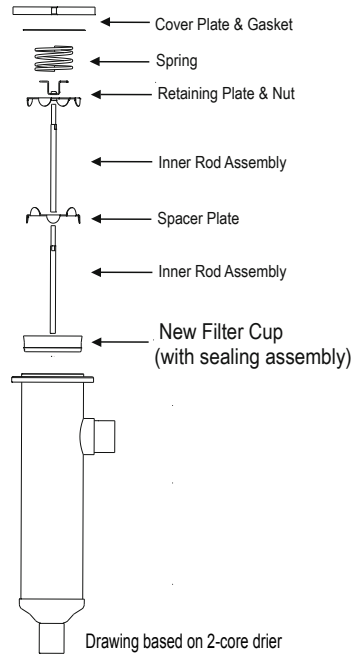

## Features

### Features

- Full range from 10kW to 509kW.
- Aluminium end plate option.
- Stainless steel mesh.
- Standardized to replace other manufactures units and cores.
- Solid copper full flow connections.
- Powder coated shell rated to 3600Kpa.

### Benefits

- Larger range to suit most applications.
- Increased operating life in low temp applications.
- Secondary particle filtration and retention.
- Drop in replacement for other common makes and will accept most cores.
- Easier installation and minimum  $\Delta$ pd.
- Suitable for harsh environments and high pressure applications.

## Manufacturing Standards

Manufactured to AS2971  
Safe Working Pressure: 3,200 kPa



## Dimensions and Capacities

3017 Series Drier Shells				Capacities kW	
Connection	Part No.	Cores	R22	Liquid Line	
				R134A	R404A
7/8"	3017-1401	1	157	139	99
7/8"	3017-1402	2	155	140	100
7/8"	3017-1403	3	155	140	100
7/8"	3017-1404	4	155	140	100
1 1/8"	3017-1801	1	206	186	133
1 1/8"	3017-1802	2	240	217	155
1 1/8"	3017-1803	3	394	226	162
1 1/8"	3017-1804	4	394	226	162
1 3/8"	3017-2201	1	259	226	162
1 3/8"	3017-2202	2	326	295	211
1 3/8"	3017-2203	3	400	365	261
1 3/8"	3017-2204	4	415	377	271
1 5/8"	3017-2601	1	259	227	162
1 5/8"	3017-2602	2	326	295	211
1 5/8"	3017-2603	3	400	365	261
1 5/8"	3017-2604	4	415	377	271
2 1/8"	3017-3401	1	259	227	162
2 1/8"	3017-3402	2	396	358	256
2 1/8"	3017-3403	3	424	389	277
2 1/8"	3017-3404	4	509	460	329

3010 Series Drier Shells				Capacities kW	
Connection	Part No.	Cores	R22	Liquid Line	
				R134A	R404
2 5/8"	3010-4202	2	396	358	256
2 5/8"	3010-4203	3	424	389	277
2 5/8"	3010-4204	4	509	460	329
3"	3010-4802	2	396	358	256
3"	3010-4803	3	424	389	277
3"	3010-4804	4	509	460	329
3 1/8"	3010-5002	2	396	359	256
3 1/8"	3010-5003	3	424	389	277
3 1/8"	3010-5004	4	509	460	329
3 1/4"	3010-5204	4	509	460	329
3 1/2"	3010-5604	4	509	460	329
3 5/8"	3010-5804	4	509	460	329
4"	3010-6404	4	509	460	329

Liquid capacities based on;  
 Evaporating temp: -15°C  
 Condensing temp: 30°C  
 pd = .07 bar

Suction Capacities based on;  
 Evaporating temp: 4.4°C  
 Condensing temp: 32.2°C

### Dimensions 3017 Series

Part No.	A inches	B mm	C
3017-1401	7/8	140	269
3017-1402	7/8	280	409
3017-1403	7/8	424	553
3017-1404	7/8	567	696
3017-1801	1 1/8	140	269
3017-1802	1 1/8	280	409
3017-1803	1 1/8	424	553
3017-1804	1 1/8	567	696
3017-2201	1 3/8	140	269
3017-2202	1 3/8	280	409
3017-2203	1 3/8	424	553
3017-2204	1 3/8	567	696
3017-2601	1 5/8	140	269
3017-2602	1 5/8	280	409
3017-2603	1 5/8	424	553
3017-2604	1 5/8	567	696
3017-3401	2 1/8	140	296
3017-3402	2 1/8	280	409
3017-3403	2 1/8	424	553
3017-3404	2 1/8	567	696

### Dimensions 3010 Series

Part No.	A inches	B mm	C
3010-4202	2 5/8"	140	269
3010-4203	2 5/8"	280	409
3010-4204	2 5/8"	424	553
3010-4802	3"	567	696
3010-4803	3"	140	269
3010-4804	3"	280	409
3010-5002	3 1/8"	424	553
3010-5003	3 1/8"	567	696
3010-5004	3 1/8"	140	269
3010-5204	3 1/4"	280	409
3010-5604	3 1/2"	424	553
3010-5804	3 5/8"	567	696
3010-6404	4"	600	710

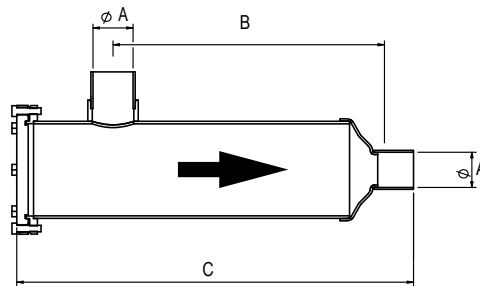

### Internal Kits

Part No.	Description	
3010-01	ONE CORE - INTERNAL incl gasket and spring	OLD STYLE
3010-02	TWO CORE - INTERNAL incl gasket and spring	OLD STYLE
3010-03	THREE CORE- INTERNAL incl gasket and spring	OLD STYLE
3010-04	FOUR CORE - INTERNAL incl gasket and spring	OLD STYLE
3017-01	ONE CORE - INTERNAL incl gasket and spring	NEW STYLE
3017-02	TWO CORE - INTERNAL incl gasket and spring	NEW STYLE
3017-03	THREE CORE- INTERNAL incl gasket and spring	NEW STYLE
3017-04	FOUR CORE - INTERNAL incl gasket and spring	NEW STYLE
3010-ALUM-ASSY	TOP PLATE - Aluminium - C/W 1/4 NPT Plug + 8 bolts & washers	
3010-TESTCERT	TEST CERTIFICATE - Request at time of order	
3053-1C	GASKET SET - Suit demountable end plate & internal core seating	
3060-76C	DRIER BRACKET - Demountable Shell	

